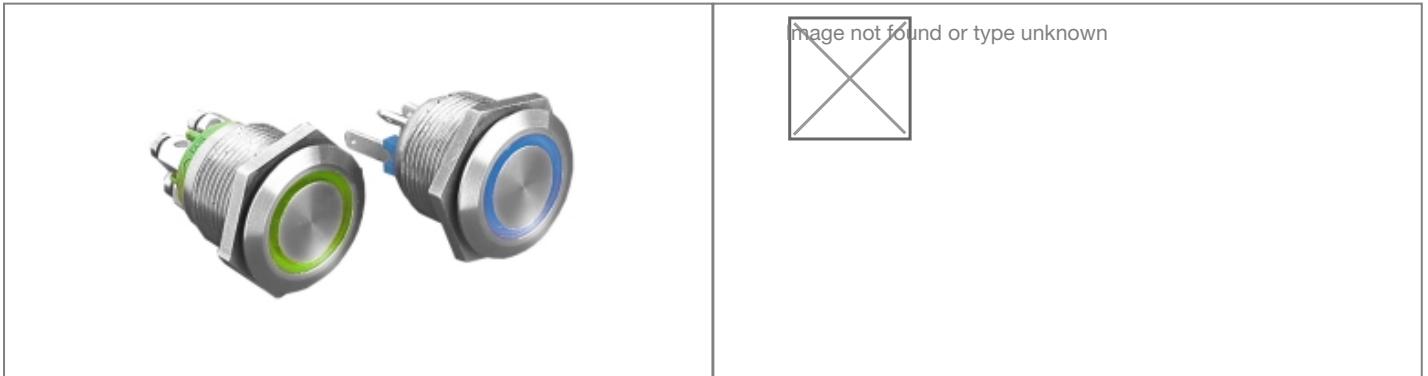

**Product Name // Stainless Steel Vandal Resistant
Illuminated IP66 Push Button Switch MPI002 Series
Red/Blue LED Ring (No Resistor) Screw Termination**

[View Product Page](#)

// Product Description:

- ⊗ Stainless Steel Illuminated Vandal Resistant Push Button Switches
- ⊗ 22mm diameter
- ⊗ Single Contact, push to make, tactile (momentary action)
- ⊗ Choice of Termination, depending on part code:
- ⊗ /28 - 2.8mm Tab
- ⊗ /TE or /TERM - Screw Terminal
- ⊗ /RP - Solder Tag
- ⊗ /FL - 300mm Flying Leads; white - switch, red - LED +, black - LED -
- ⊗ Choice of Illumination style depending on part code:
- ⊗ Part codes prefixed MPI001 - Centre dot
- ⊗ Part codes prefixed MPI002 - Ring
- ⊗ Choice of LED colour depending on part code:
- ⊗ Single colour: /RD - Red, /GN - Green, /AM - Amber, /BL - Blue, /WH - White
- ⊗ Dual colour (only available in /28 2.8mm Tab and /TE Screw Terminal versions): /D1 - Red/Green, /D4 - Red/Blue, /D5 - Green/Blue
- ⊗ (When dual colour LEDs are forward biased the first colour is lit, when reverse biased the second colour is lit)
- ⊗ Choice of LED operating voltage depending on part code suffix:
- ⊗ Resistor installed for operation at a single fixed voltage: /6 - 6V DC, /12 - 12V DC, /24 - 24V DC
- ⊗ Also available with no resistor installed (no suffix) - see data for ratings to enable calculation of suitable series resistor value for application
- ⊗ Front panel seal to IP66 (microswitch not sealed). /RP Solder Tag versions are also rear panel sealed to IP66

// General Information:

Product Display Title:	Stainless Steel Illuminated Vandal Resistant Push Button Switches
Product Family:	Switches
Product Series:	Push Button
Body Material:	SS 304
Current Max:	0.05A
Diameter:	22mm
Function:	Momentary Action
Illumination Colour:	Red/Blue
Illumination Shape:	Ring
Illumination Style:	Illuminated
Illumination Voltage:	No Resistor
Ip Rating:	IP66
Max Operating Temperature:	+70°C
Min Operating Temperature:	-30°C
Thread Size:	0.747 inch x 26TPI
Voltage Max:	24V

// Product PDF Links

[Vandal Resistant switches product...](#)

// Product 3D CAD Model Links

[MPI002/TERM/D43D CAD Model](#)