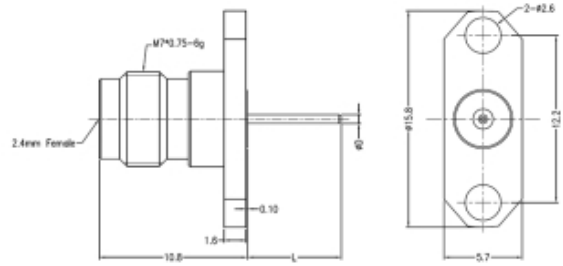

Product Name // 2.4mm Plug Straight 2 Hole Flange RF Connector
[View Product Page](#)

* Representative product image only

// Product Description:

- ⊞ 2.4mm Plug Straight 2 Hole Flange RF Connector
- ⊞ Maximum Voltage: 150V
- ⊞ Temperature range: -40°C to +85°C
- ⊞ Frequency range: 0GHz - 50GHz
- ⊞ VSWR: <1.30
- ⊞ Dielectric withstanding Voltage: >500V
- ⊞ Impedance: 50Ohm
- ⊞ Body Material: Stainless Steel Passivation
- ⊞ Contact Material: Beryllium Copper

// General Information:

| | |
|----------------------------------|-------------------------------------------------------|
| Product Display Title: | 2.40mm Series Pin without Extended PTFE 2 Hole Flange |
| Product Family: | Radio Frequency Connectors |
| Product Series: | 2.40mm Series |
| Body Length: | 12.70mm |
| Body Material: | Stainless Steel Passivation |
| Centre Contact Retention Force: | >20N |
| Contact Pin Material: | Beryllium Copper |
| Min Coupling Torque: | 0.80Nm |
| Max Coupling Torque: | 1.10Nm |
| Dielectric Withstanding Voltage: | >500V |
| Durability: | >500 cycles |
| Flange Mount Length: | 15.80mm |
| Function: | Male Flange Mount RF Connector |
| Impedance: | 50Ohm |
| Insulation Resistance: | >5000MOhm |
| Insulator: | UNFILLED ULTEM 1000/PEI |
| Max Operating Temperature: | +85°C |
| Min Operating Temperature: | -40°C |
| Mount Hole Distance: | 12.20mm |
| Min Operating Frequency: | 0GHz |
| Max Operating Frequency: | 50GHz |
| Pin Diameter: | 0.64mm |
| Pin Length: | 10.00mm |
| Voltage Max: | 150V |
| Vswr: | <1.30 |

// Product PDF Links
[2.40mm Series Product Datasheet](#)
// Product 3D CAD Model Links
[RF240A2PEGDO3D CAD Model](#)

 Have a question or project enquiry
 you'd like to talk to us about?

[Click Here To Contact Us](#)