

Product Name // 2.4mm Plug Straight 4 Hole Flange RF Connector
 [View Product Page](#)

* Representative product image only

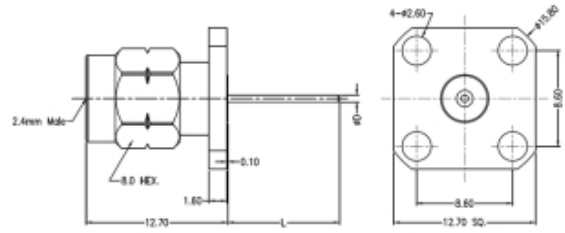

// Product Description:

- ⊕ 2.4mm Plug Straight 4 Hole Flange RF Connector
- ⊕ Maximum Voltage: 150V
- ⊕ Temperature range: -40°C to +85°C
- ⊕ Frequency range: 0GHz - 50GHz
- ⊕ VSWR: <1.30
- ⊕ Dielectric withstanding Voltage: >500V
- ⊕ Impedance: 50Ohm
- ⊕ Body Material: Stainless Steel Passivation
- ⊕ Contact Material: Beryllium Copper

// General Information:

| | |
|----------------------------------|---|
| Product Display Title: | 2.40mm Series Pin without Extended PTFE 4 Hole Flange |
| Product Family: | Radio Frequency Connectors |
| Product Series: | 2.40mm Series |
| Body Length: | 12.70mm |
| Body Material: | Stainless Steel Passivation |
| Centre Contact Retention Force: | >20N |
| Contact Pin Material: | Beryllium Copper |
| Min Coupling Torque: | 0.80Nm |
| Max Coupling Torque: | 1.10Nm |
| Dielectric Withstanding Voltage: | >500V |
| Durability: | >500 cycles |
| Flange Mount Length: | 12.70mm |
| Function: | Male Flange Mount RF Connector |
| Impedance: | 50Ohm |
| Insulation Resistance: | >5000MOhm |
| Insulator: | UNFILLED ULTEM 1000/PEI |
| Max Operating Temperature: | +85°C |
| Min Operating Temperature: | -40°C |
| Mount Hole Distance: | 8.60mm |
| Min Operating Frequency: | 0GHz |
| Max Operating Frequency: | 50GHz |
| Pin Diameter: | 0.64mm |
| Pin Length: | 10.00mm |
| Voltage Max: | 150V |
| Vswr: | <1.30 |

// Product PDF Links

 [2.40mm Series Product Datasheet](#)

// Product 3D CAD Model Links

 [RF240A4PCCDO3D CAD Model](#)