

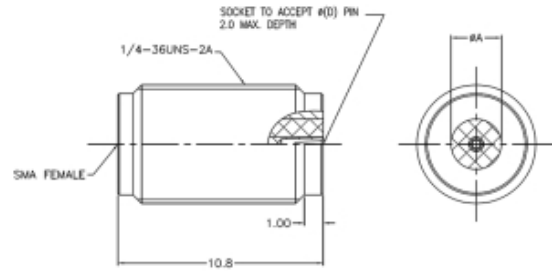









**Product Name // SMA Straight Jack RF Connector, Bulkhead**
 [View Product Page](#)

\* Representative product image only



## // Product Description:

-  SMA Straight Jack RF Connector, Bulkhead
-  Maximum Voltage: 335V
-  Temperature range: -65°C to +165°C
-  Frequency range: 0GHz - 26.5GHz
-  VSWR: <1.30
-  Dielectric withstanding Voltage: >750V
-  Impedance: 50Ohm
-  Body Material: Stainless Steel Passivation
-  Contact Material: Beryllium Copper

## // General Information:

Product Display Title:	SMA Series Bulkhead
Product Family:	Radio Frequency Connectors
Product Series:	SMA Series
Body Length:	10.80mm
Body Material:	Stainless Steel Passivation
Centre Contact Retention Force:	>26.7N
Contact Pin Material:	Beryllium Copper
Min Coupling Torque:	0.80Nm
Max Coupling Torque:	1.10Nm
Coupling Nut Retention Force:	>27.2Kgf
Dielectric Withstanding Voltage:	>750V
Durability:	>500 cycles
Function:	Female RF Bulkhead
Impedance:	50Ohm
Insulation Resistance:	>5000MOhm
Insulator:	Adapter ASTM D 1710
Max Operating Temperature:	+165°C
Min Operating Temperature:	-65°C
Min Operating Frequency:	0GHz
Max Operating Frequency:	26.5GHz
Socket Diameter:	0.30mm
Socket Outer Diameter:	1.94mm
Thread Size:	1/4 36UNS 2A
Voltage Max:	335V
Vswr:	<1.30

## // Product PDF Links

 [SMA Series Product Datasheet](#)

## // Product 3D CAD Model Links

 [RFSMAAJB3D CAD Model](#)