



- ⬡ IP68 rating tested at 1.054kg/sq cm (15lb/sq in)
- ⬡ 10m depth for 2 weeks
- ⬡ 2, 3, 4, 5, 7 and 10 Contact
- ⬡ Leading earth contact for 3, 4, 5 & 7 Contact versions
- ⬡ Trailing Neutral on 5 Contact
- ⬡ Plug or socket connection in each body style
- ⬡ Water and dustproof to IP68 when mated
- ⬡ Cost effective solution
- ⬡ Two cable connector versions for 15mm and 22mm (maximum) cable diameters
- ⬡ 'Scoop proof' contacts
- ⬡ Field termination - screw terminations
- ⬡ Positive locating keyways - cannot be mis-connected
- ⬡ Sealing caps available to maintain IP68 rating of unmated connectors
- ⬡ Compact design
- ⬡ Easy assembly - no special tools required
- ⬡ Single or 3 phase applications
- ⬡ Cable acceptance from 7 to 22mm O/D
- ⬡ Separate strain relief on large cable version

Flex Cable Connector



EXP-0911

Flex Cable Connector



EXP-A911

- Mates with Inline or panel mounting versions
- Positive, fast acting locking ring - can be turned with a gloved hand
- Plug or socket versions
- EXP-0 Series 13-15mm cable dia. acceptance as standard, 7-13mm with additional Gland Pack PX0980
- EXP-A Series 20-22mm cable dia. Acceptance as standard, 14-20mm with additional Gland Pack PXA980
- Strain Relief Clamp

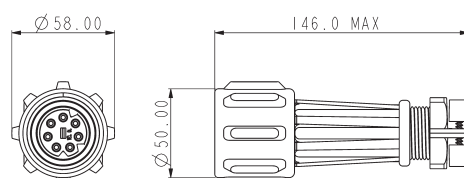
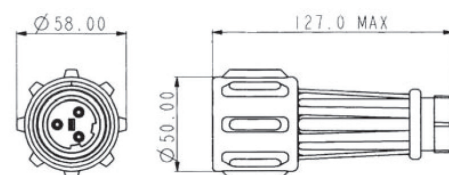

Standard Cable	Large Cable	Description	Standard Cable	Large Cable	Description
EXP-0911/02/P	EXP-A911/02/P	2 Contact Plug	EXP-0911/02/S	EXP-A911/02/S	2 Contact Socket
EXP-0911/03/P	EXP-A911/03/P	3 Contact Plug	EXP-0911/03/S	EXP-A911/03/S	3 Contact Socket
EXP-0911/04/P	EXP-A911/04/P	4 Contact Plug	EXP-0911/04/S	EXP-A911/04/S	4 Contact Socket
EXP-0911/05/P	EXP-A911/05/P	5 Contact Plug	EXP-0911/05/S	EXP-A911/05/S	5 Contact Socket
EXP-0911/07/P	EXP-A911/07/P	7 Contact Plug	EXP-0911/07/S	EXP-A911/07/S	7 Contact Socket
EXP-0911/10/P	EXP-A911/10/P	10 Contact Plug	EXP-0911/10/S	EXP-A911/10/S	10 Contact Socket

Inline Cable Connector



EXP-0921

Inline Cable Connector



EXP-A921

- Mates with either EXP-0911 or EXP-A911 connectors
- Plug or socket versions
- EXP-0 Series 13-15mm cable dia. acceptance as standard, 7-13mm with additional Gland Pack PX0980
- EXP-A Series 20-22mm cable dia. acceptance as standard, 14-20mm with additional Gland Pack PXA980
- Strain Relief Clamp

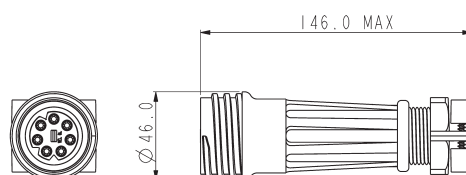
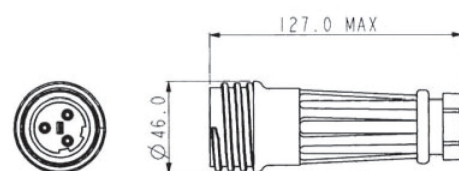

Standard Cable	Large Cable	Description	Standard Cable	Large Cable	Description
EXP-0921/02/P	EXP-A921/02/P	2 Contact Plug	EXP-0921/02/S	EXP-A921/02/S	2 Contact Socket
EXP-0921/03/P	EXP-A921/03/P	3 Contact Plug	EXP-0921/03/S	EXP-A921/03/S	3 Contact Socket
EXP-0921/04/P	EXP-A921/04/P	4 Contact Plug	EXP-0921/04/S	EXP-A921/04/S	4 Contact Socket
EXP-0921/05/P	EXP-A921/05/P	5 Contact Plug	EXP-0921/05/S	EXP-A921/05/S	5 Contact Socket
EXP-0921/07/P	EXP-A921/07/P	7 Contact Plug	EXP-0921/07/S	EXP-A921/07/S	7 Contact Socket
EXP-0921/10/P	EXP-A921/10/P	10 Contact Plug	EXP-0921/10/S	EXP-A921/10/S	10 Contact Socket

Front Panel Mounting Connector



EXP-0931

- Mates with EXP-0911 and EXP-A911 connectors
- Single hole fixing
- Anti-rotation key
- High grade sealing gasket
- 3-7mm panel thickness

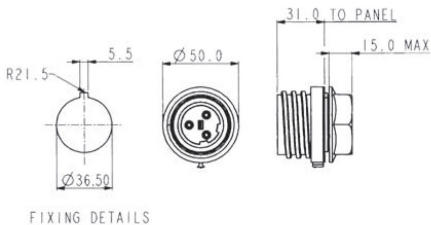

Panel Mounting

EXP-0931/02/P	2 Contact Plug	EXP-0931/02/S	2 Contact Socket
EXP-0931/03/P	3 Contact Plug	EXP-0931/03/S	3 Contact Socket
EXP-0931/04/P	4 Contact Plug	EXP-0931/04/S	4 Contact Socket
EXP-0931/05/P	5 Contact Plug	EXP-0931/05/S	5 Contact Socket
EXP-0931/07/P	7 Contact Plug	EXP-0931/07/S	7 Contact Socket
EXP-0931/10/P	10 Contact Plug	EXP-0931/10/S	10 Contact Socket

Flange Mounting Connector



EXP-0941

- Mates with EXP-0911 and EXP-A911 connectors
- Supplied with high grade sealing gasket
- Supplied with sealing grommets for panel fixing screws (M6 thread recommended)

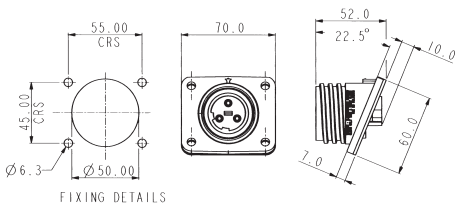

Panel Mounting

EXP-0941/02/P	2 Contact Plug	EXP-0941/02/S	2 Contact Socket
EXP-0941/03/P	3 Contact Plug	EXP-0941/03/S	3 Contact Socket
EXP-0941/04/P	4 Contact Plug	EXP-0941/04/S	4 Contact Socket
EXP-0941/05/P	5 Contact Plug	EXP-0941/05/S	5 Contact Socket
EXP-0941/07/P	7 Contact Plug	EXP-0941/07/S	7 Contact Socket
EXP-0941/10/P	10 Contact Plug	EXP-0941/10/S	10 Contact Socket

Sealing Caps



EXP-0990, EXP-0991, EXP-0992

- Heavy duty sealing caps to maintain IP68 rating of unmated connectors, with stainless steel straps

Sealing Caps

EXP-0990	Heavy duty sealing cap for use with EXP-0911/xx/x and EXP-A911/xx/x
EXP-0991	Heavy duty sealing cap for use with EXP-0921/xx/x and EXP-A921/xx/x
EXP-0992	Heavy duty sealing cap for use with EXP-0931 and EXP-0941

Cable Glands



PX0980, PXA980

- Packs of 3 additional pairs Cable Glands for 900 Series Flex Cable Connectors

Gland Packs

EXP-0980	Pack of 3 additional cable glands for EXP-0911 and EXP-0921 to suit cable sizes: 7-9mm (Dark Grey), 9-11mm (White) and 11-13mm (Black) diameter
EXP-A980	Pack of 3 additional cable glands for EXP-A911 and EXP-A921 to suit cable sizes: 14-16mm (Dark Grey), 16-18mm (White) and 18-20mm (Black) diameter

Electrical:

No Contacts:	2, 3, 4, 5	7	10
Current Rating:	18A	16A	10A
Voltage Rating:	600V AC/DC	430V AC/DC	250V AC/DC
Contact Resistance:	<10mΩ (initial)		
Insulation Resistance:	>10 ⁹ MΩ (@ 500V DC)		
Dielectric strength:	2.2kV DC min		
AC Breakdown voltage:	6kV		
Ambient Temperature Range:	-20°C to +55°C		

Materials:

Body Mouldings:	Polyester
Cap Mouldings:	Polycarbonate
Flammability Rating:	UL94V-0
Contacts:	Machined Solid Brass, Nickel plated
O Rings:	Nitrile Panel
Sealing Gasket:	Silicone Rubber
RoHS	Compliant

Mechanical:

Sealing:	IP68, EN60529:2001 tested @ 1.054kg/sq.cm. (15lb/sq.in.) 10m depth for 2 weeks
Cable Acceptance:	EXP-0911 - EXP-0921 13 - 15mm O/D standard, 7-13mm with Gland Pack PX0980 EXP-A911 - EXP-A921 20 - 22mm O/D standard, 14 - 20mm with Gland Pack PXA980
Contact Accommodation:	2-7 Contact - 2.5 to 4mm ² (14 to 10AWG) conductor, single or multi stranded 10 Contact - 0.75 to 2mm ² (14 to 18AWG) conductor, single or multi stranded
Termination:	Axial screw terminals 22mm dia, 150N 15mm dia, 150N 7mm dia, 80N
Cable Retention force:	
Gland Nut Torques:	
EXP-0 range	3.16Nm (28lbf/in)
13-15mm (Yellow - std.)	3.16Nm (28lbf/in)
11-13mm (black)	3.16Nm (28lbf/in)
9-11mm (white)	3.16Nm (28lbf/in)
7-9mm (dark grey)	
EXP-A range	
20-22mm (Yellow - std.)	3.16Nm (28lbf/in)
18-20mm (black)	3.16Nm (28lbf/in)
16-18mm (white)	3.16Nm (28lbf/in)
14-16mm (dark grey)	3.16Nm (28lbf/in)
Tightening Torques:	
Panel mount nut	2.25Nm
Flange & Bulkhead fixing screws	0.9Nm
Rear thread EXP-0931 series	M36 x 2-6g