



- ⊕ IP68 when mated, Tested in accordance with EN60529:1992+A2:2013
- ⊕ IP69K when mated, Tested in accordance with DIN 40050/Part 9 IP69k
- ⊕ EN60068-2-52 Test Kb Salt Mist (Cyclic) Marine Severity Level 1
- ⊕ Secure, proven & reliable screw locking mechanism
- ⊕ PUR / PVC Jacket on cable
- ⊕ Chemical resistance & flame retardant
- ⊕ Cat 8 toolless Keystone IDC connector
- ⊕ Data rates up to 25Gbps
- ⊕ Backwards compatibility throughout
- ⊕ Cat 5e or Cat 6a Shielded coupler
- ⊕ Rewireable Flex connector up to Cat 6a
- ⊕ Field termination up to Cat 6a
- ⊕ Earth lead version of panel mounting coupler
- ⊕ Cat 5e PCB Mount & IDC termination panel connector
- ⊕ High noise immunity, full shielding and EMI protection
- ⊕ Power over Ethernet (PoE) compliant

Patch Cord Flex Connector



PX0836

- Mates with all panel mounting connectors
- Patchcords with IP68 connector
- Supplied with shielded RJ45 plug
- Single or double end terminated
- Standard lengths: 2m, 3m & 5m
- S-FTP cable construction
- PUR (Cat 5e) or PVC (Cat 6a / 8) jacket cable
- Wiring configuration to 568-B

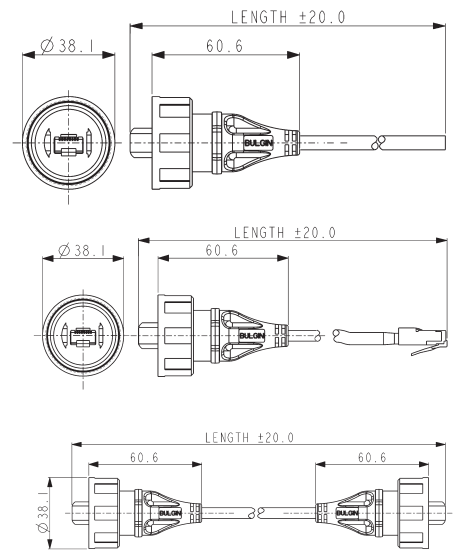

| Part no. | Type | Length | Description |
|-------------|--------------|--------|---|
| PX0836/2M00 | Wire end | 2m | Cat 5e IP68 RJ45 Buccaneer to bare end |
| PX0836/3M00 | Wire end | 3m | Cat 5e IP68 RJ45 Buccaneer to bare end |
| PX0836/5M00 | Wire end | 5m | Cat 5e IP68 RJ45 Buccaneer to bare end |
| PX0837/2M00 | Single ended | 2m | Cat 5e IP68 RJ45 Buccaneer to Shielded RJ45 |
| PX0837/3M00 | Single ended | 3m | Cat 5e IP68 RJ45 Buccaneer to Shielded RJ45 |
| PX0837/5M00 | Single ended | 5m | Cat 5e IP68 RJ45 Buccaneer to Shielded RJ45 |
| PX0838/2M00 | Double ended | 2m | Cat 5e IP68 RJ45 Buccaneer to IP68 RJ45 Buccaneer |
| PX0838/3M00 | Double ended | 3m | Cat 5e IP68 RJ45 Buccaneer to IP68 RJ45 Buccaneer |
| PX0838/5M00 | Double ended | 5m | Cat 5e IP68 RJ45 Buccaneer to IP68 RJ45 Buccaneer |
| PX0896/2M00 | Wire end | 2m | Cat 6a IP68 RJ45 Buccaneer to bare end |
| PX0896/3M00 | Wire end | 3m | Cat 6a IP68 RJ45 Buccaneer to bare end |
| PX0896/5M00 | Wire end | 5m | Cat 6a IP68 RJ45 Buccaneer to bare end |
| PX0897/2M00 | Single ended | 2m | Cat 6a IP68 RJ45 Buccaneer to Shielded RJ45 |
| PX0897/3M00 | Single ended | 3m | Cat 6a IP68 RJ45 Buccaneer to Shielded RJ45 |
| PX0897/5M00 | Single ended | 5m | Cat 6a IP68 RJ45 Buccaneer to Shielded RJ45 |
| PX0898/2M00 | Double ended | 2m | Cat 6a IP68 RJ45 Buccaneer to IP68 RJ45 Buccaneer |
| PX0898/3M00 | Double ended | 3m | Cat 6a IP68 RJ45 Buccaneer to IP68 RJ45 Buccaneer |
| PX0898/5M00 | Double ended | 5m | Cat 6a IP68 RJ45 Buccaneer to IP68 RJ45 Buccaneer |
| PX0857/2M00 | Single ended | 2m | Cat 8 IP68 RJ45 Buccaneer to IP68 Shielded RJ45 |
| PX0857/3M00 | Single ended | 3m | Cat 8 IP68 RJ45 Buccaneer to IP68 Shielded RJ45 |
| PX0857/5M00 | Single ended | 5m | Cat 8 IP68 RJ45 Buccaneer to IP68 Shielded RJ45 |
| PX0858/2M00 | Double ended | 2m | Cat 8 IP68 RJ45 Buccaneer to IP68 RJ45 Buccaneer |
| PX0858/3M00 | Double ended | 3m | Cat 8 IP68 RJ45 Buccaneer to IP68 RJ45 Buccaneer |
| PX0858/5M00 | Double ended | 5m | Cat 8 IP68 RJ45 Buccaneer to IP68 RJ45 Buccaneer |

Re Wireable Flex Connector



PX0834

- Mates with all panel mounting connectors
- Supplied with shielded RJ45 plug
- Two versions:
- Cat 5e or Cat 6a Cable size from 5 to 6mm diameter, or extra cable glands for other cable sizes from 3.5 to 8mm diameter.

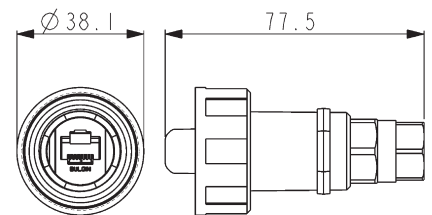

| Part no. | Description |
|----------|---|
| PX0834/A | Cat 5e suitable for use with cables from 5 to 6mm diameter |
| PX0834/B | Cat 5e with 2 extra cable glands, suitable for use with cables from 3.5 to 8mm diameter |
| PX0894/A | Cat 6a suitable for use with cables from 5 to 6mm diameter |
| PX0894/B | Cat 6a with 2 extra cable glands, suitable for use with cables from 3.5 to 8mm diameter |

Front Panel Mounting Coupler Connector



PX0833

- Cat 5e mates with PX0836, PX0837, PX0838 & PX0834 flex connectors
- Cat 6a mates with PX0896, PX0897, PX0898 & PX0894 flex connectors
- Standard RJ45 patchcord can be plugged into rear
- Version with earth wire available
- Single hole fixing
- Complete with panel sealing gasket

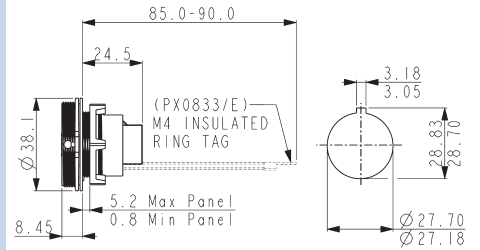

| Part no. | Description | Fixing |
|----------|-----------------------------|---------------------|
| PX0833 | Cat 5e coupler | Front panel mounted |
| PX0833/E | Cat 5e coupler + earth wire | Front panel mounted |
| PX0893 | Cat 6a coupler | Front panel mounted |
| PX0893/E | Cat 6a coupler + earth wire | Front panel mounted |

Front Panel Mounting Keystone Connector



PX0855/KS

- Backwards compatible with all flex connectors
- Cat 8 mates with PX0857, PX0858 flex connectors
- Toolless jack termination
- Maintains shielding ground continuity
- Single hole fixing
- Complete with panel sealing gasket

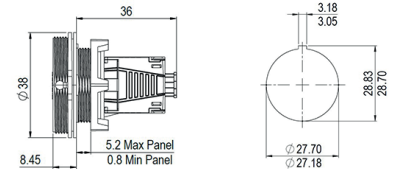

| Part no. | Description | Fixing |
|-----------|--------------------------|---------------------|
| PX0855/KS | Cat 8 Keystone connector | Front panel mounted |

Rear Panel Mounting Keystone Connector



PX0856/KS

- Backwards compatible with all flex connectors
- Cat 8 mates with PX0857, PX0858 flex connectors
- Toolless jack termination
- Maintains shielding ground continuity
- Single hole fixing
- Complete with panel sealing gasket

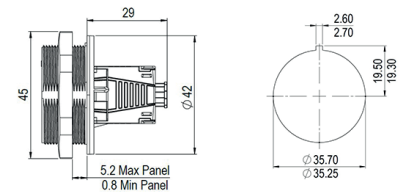

| Part no. | Description | Fixing |
|-----------|--------------------------|--------------------|
| PX0856/KS | Cat 8 Keystone connector | Rear panel mounted |

Flange Mounting Connector



PX0870

- Cat 5e mates with PX0836, PX0837, PX0838 & PX0834 flex connectors
- Cat 6a mates with PX0896, PX0897, PX0898 & PX0894 flex connectors
- Standard RJ45 patchcord can be plugged into rear
- Version with earth wire available

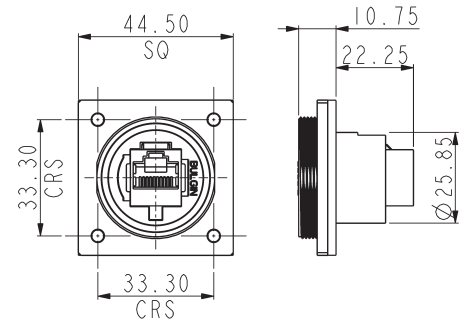

| Part no. | Description | Fixing |
|----------|-----------------------------|-----------------|
| PX0870 | Cat 5e coupler | Flange mounting |
| PX0870/E | Cat 5e coupler + earth wire | Flange mounting |
| PX0890 | Cat 6a coupler | Flange mounting |
| PX0890/E | Cat 6a coupler + earth wire | Flange mounting |

PCB Mounting Connector



PX0839/PC

- Cat 5e shielded RJ45 interface
- Rear of panel mounted
- Mates with PX0836, PX0837, PX0838 and PX0834 flex connectors
- For direct vertical mounting to PCB, straight Plugs
- Complete with panel sealing PX0839/PC gasket

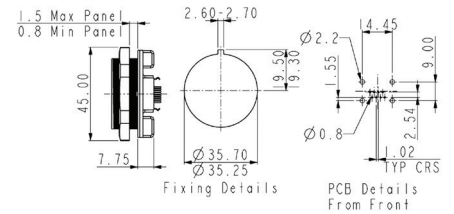

| Part no. | Description | Fixing |
|-----------|-----------------------|--------------------|
| PX0839/PC | Cat 5e connector - PC | Rear panel mounted |

PCB Mounting Connector



PX0839/90

- Cat 5e shielded RJ45 interface
- Rear of panel mounted
- Mates with PX0836, PX0837, PX0838 and PX0834 flex connectors
- For direct horizontal mounting to PCB, 90° Plugs
- Complete with panel sealig PX0839/90 gasket

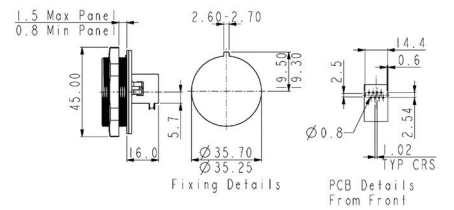

| Part no. | Description | Fixing |
|-----------|------------------------------------|--------------------|
| PX0839/90 | Cat 5e connector - 90 degree Plugs | Rear panel mounted |

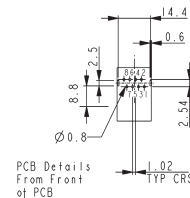

Panel Mounting Connector



PX0839/IDC

- Cat 5e shielded RJ45 interface
- Rear of panel mounted
- Mates with PX0836, PX0837, PX0838 and PX0834 flex connectors
- Two IDC blocks for discrete termination
- Complete with panel sealing

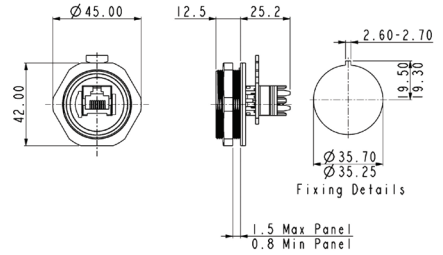

| Part no. | Description | Fixing |
|------------|----------------------|--------------------|
| PX0839/IDC | Cat 5e coupler - IDC | Rear panel mounted |

Shield Back Shell Accessory



PX0888

- Maintains RJ45 coupler screening directly to panel
- Shielding can is fixed to rear of panel mount connector
- For use on PX0833, PX0893 & PX0855

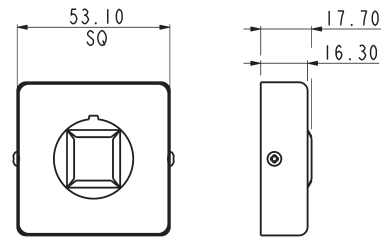

| Part no. | Description |
|----------|-------------------------------|
| PX0888 | Shielding backshell accessory |

Accessories



Sealing Caps

- Sealing caps to maintain IP68 rating when connectors are not in use
- Replacement shielded RJ45s
- Hand crimp tool for shielded RJ45
- Patch cord cable available in 50m reels

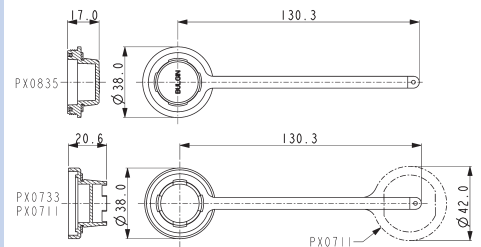

| Part no. | Description |
|----------|--|
| PX0835 | Sealing Cap for use on all ethernet flex connectors |
| PX0733 | Sealing Cap for use on all front panel mounting connectors |
| PX0711 | Sealing Cap for use on all rear panel mounting connectors |
| 14151 | Cat 5e & Cat 6a Hand crimp tooling + die set |
| 14199 | Cat 5e PUR Jacket Cable - 50m reel |
| 14150 | Cat 5e Replacement shielded RJ45 |
| 15241 | Cat 6a PVC Jacket Cable - 50m reel |

| Connectors | Cat 5e & 6a | Cat 8 |
|-------------------------|--|--|
| Sealing: | IP68, EN60529:1992+A2:2013 (10m depth for 2 weeks) | IP68, EN60529:1992+A2:2013 (10m depth for 2 weeks) |
| | IP69K, Tested in accordance with DIN 40050/Part 9 IP6k9k | IP69K, Tested in accordance with DIN 40050/Part 9 IP6k9k |
| Operating Temperature: | -20°C to +70°C | -20°C to +60°C |
| Materials - Overmoulded | | |
| Overmould material: | PVC (black) | Polyamide (black) |
| Flammability rating: | UL94V-0 | UL94V-0 |
| Salt Mist: | EN60068-2-52 Test Kb Salt Mist (Cyclic) Marine Severity Level 1 | EN60068-2-52 Test Kb Salt Mist (Cyclic) Marine Severity Level 1 |

Materials - Re-wireable and Panel Connectors

| | |
|-------------------------------|-----------|
| Connector body & locking ring | Polyester |
| Panel connector | Nylon 6 |
| Flammability rating | UL94V-0 |
| 'O' rings | Silicone |
| Panel Gasket - round | Silicone |
| Panel Gasket - flange | Neoprene |
| RoHS | Compliant |

| Cables & POE | Cat 5e | Cat 6a | Cat 8 |
|--|-----------------------------------|---|---|
| Conductors | 24AWG (7/0.2mm) bare copper | 26AWG (7/0.16mm) bare copper | 26AWG (7/0.16mm) bare copper |
| Insulation | HD-PE | PE (Skin - Foam - Skin) | N/A |
| Pair | 2 of the above cores twisted | 2 of the above cores twisted | 2 of the above cores twisted |
| Core | 4 of the above cores | 4 of the above cores | 4 of the above cores |
| Screen | 1 layer mylar and aluminium tape, | Aluminium & Polyester | Aluminium & Polyester |
| Braid | 0.12mm tinned copper braid | Tinned Copper Braid | Tinned Copper Braid |
| Jacket | PUR (Black) | PVC (Black) | PVC (Black) |
| Op Temperature | -25°C to +85°C | -25°C to +75°C | -20°C to +60°C |
| Diameter | 6.1mm nominal | 6.0 mm nominal | 6.0 mm nominal |
| Flame Test | | FT4 | |
| Electrical @ 20°C | | | |
| Characteristic: | | | |
| Impedance | 100 Ω ±15 Ω @ 100MHz | | |
| Capacitance | 330pF/km | | |
| Conductor Loop | | | |
| Resistance | 29/Ω100m maximum | 26Ω /km | |
| Skew | 45 nsec/100m @ 100MHz | | |
| PoE Standard: | IEEE 802.3af (2 pair) | IEEE 802.3bt, Type 4 (4 pair) 4PoE++ | IEEE 802.3bt, Type 4 (4 pair) 4PoE++ |
| Power rating | 12.95W | 71W | 71W |
| Current rating | 350mA | 960mA | 1500mA |
| Voltage rating (DC) | 44-57V | 41.1V-57V | 72V |
| Mechanical Characteristics | | | |
| Minimum Tensile Strength of Jacket (kgf/mm ²) | | 1.05 | |
| Maximum Length for Strip of Jacket (mm) | | 40 | |

Cable construction - CAT 5e

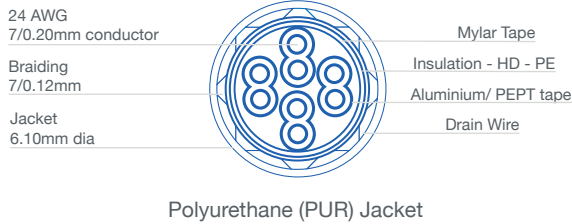

Cable construction - Cat 6a & Cat 8

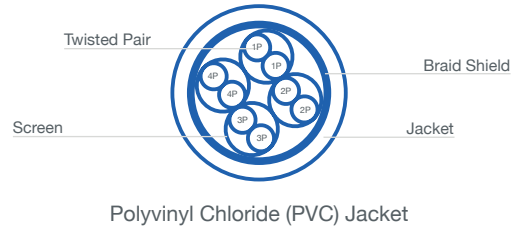

| RJ45 Plug | Cat 5e & PoE | Cat 6a | Cat 8 |
|-----------------------|----------------------------------|----------------------------------|---------------------------------------|
| Materials | | | |
| Moulding | Polycarbonate | Polycarbonate | Polycarbonate |
| Shielding | | | Zinc Alloy |
| Flammability | UL94V-0 | UL94V-0 | UL94V-2 |
| Contact material | Phosphor Bronze | Phosphor Bronze | Phosphor Bronze |
| Contact plating | 50-micron gold | 50-micron gold | 50-micron gold |
| Operating Temperature | -40°C to +70°C | -40°C to +70°C | -20°C to +60°C |
| Mating cycles | 1,000 cycles | 1,000 cycles | 1,200 cycles |
| RoHS | Compliant | Compliant | Compliant |
| Electrical | | | |
| No. Conductors | 8 | 8 | 8 |
| Conductor types | 24-28AWG, solid or multistranded | 24-28AWG, solid or multistranded | 26AWG, multistranded (pre-terminated) |
| Current rating | 350mA | 1500mA | 1500mA |
| Voltage rating | 37V AC, 57V DC | 30V AC, 42V DC | 72V DC |
| Contact resistance | 10mΩ | 10mΩ | 20mΩ max. |

Cat 8 (Keystone)

| | |
|-----------------------|---------------------------------|
| Materials | |
| Coupler Shell | Zinc |
| Coupler Plating | Nickel |
| Moulding | PC |
| IDC Housing | PC |
| IDC Cap | PC + glass fibre |
| IDC Terminal | Tin plated Phosphor Bronze |
| Ground Contact | Stainless steel, Copper foil |
| Tie wrap | Nylon 6/6 |
| Flammability | UL94V-2 |
| Contact material | Phosphor Bronze |
| Contact plating | 50-micron gold |
| Operating Temperature | -10°C to +60°C |
| Mating cycles - Jack | >750 cycles |
| Mating cycles - IDC | >20 terminations |
| RoHS | Compliant |
| Electrical | |
| No. Conductors | 8 |
| Current rating | 1.5A |
| Voltage rating | 100V DC |
| Dielectric Withstand | 1000V DC/AC @ 60hz for 1 minute |
| Contact resistance | 10mΩ max. |

| RJ45 Coupler | Cat 5e | Cat 6a |
|-----------------------|-----------------|-----------------|
| Materials | | |
| Coupler Shell | Copper Alloy | Copper Alloy |
| Coupler Plating | Nickel | Nickel |
| Moulding | PBT | PBT |
| Flammability | UL94V-0 | UL94V-0 |
| Contact material | Phosphor Bronze | Phosphor Bronze |
| Contact plating | 50 micron gold | 50 micron gold |
| Operating Temperature | -40°C to +70°C | 0°C to +70°C |
| Mating cycles | 1,000 cycles | 1,000 cycles |
| RoHS | Compliant | Compliant |
| Electrical | | |
| No. Conductors | 8 | 8 |
| Current rating | 1.5A | 1.5A |
| Voltage rating | 30V AC, 42V DC | 30V AC, 42V DC |
| Contact resistance | 10mΩ max. | 10mΩ max. |

| RJ45 PCB Connector | Cat 5e |
|-----------------------|-----------------|
| Materials | |
| Coupler Shell | Copper Alloy |
| Coupler Plating | Nickel |
| Moulding | PBT |
| Flammability | UL94V-0 |
| Contact material | Phosphor Bronze |
| Contact plating | 50 micron gold |
| PC Plugs | Tin plated |
| Operating Temperature | -40°C to +70°C |
| Mating cycles | 1,000 cycles |
| RoHS | Compliant |
| Electrical | |
| No. Conductors | 8 |
| Current rating | 1.5A |
| Voltage rating | 30V AC, 42V DC |
| Contact resistance | 10mΩ max. |

Cable Joiner



PX0777

- IP68 Rating
- For Sealed Inline RJ45 Connections
- Supplied Complete with Coupler
- Shielded (STP) & Unshielded (UTP) versions
- Cat5e Shielded Coupler also available
- Cable Range 3.5 - 8mm (with glands supplied)

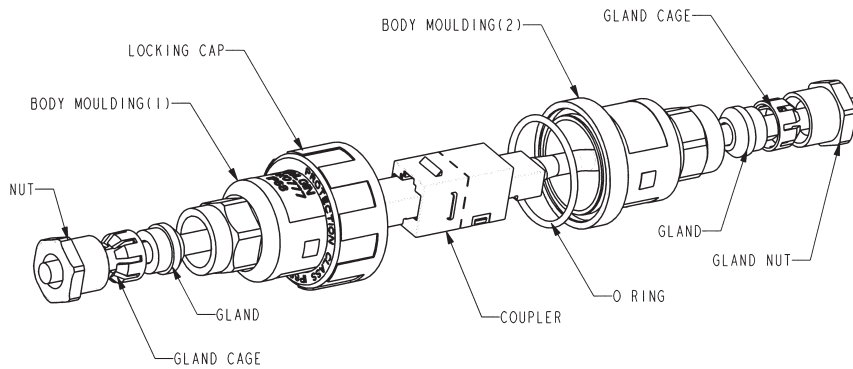
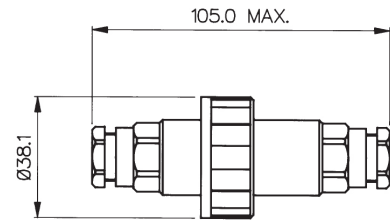

| Specifications | PX0777/UTP | PX0777/STP | PX0777/CAT5ESTP | PX0777/CAT6ASTP |
|-----------------------|--|--|--|--|
| Rating: | 1.5A, 30V AC, 42V DC | 1.5A, 30V AC, 42V DC | 1.5A, 30V AC, 42V DC | 1.5A, 30V AC, 42V DC |
| No. of Conductors: | 8 | 8 | 8 | 8 |
| Coupler Type: | Unshielded | Shielded | Shielded CAT5e performance | Shielded CAT6a performance |
| Cable Range: | 3.5 - 8mm With glands supplied: 3.5 - 5mm (Blue) 5 - 7mm (Green) 6 - 8mm (Red) | 3.5 - 8mm With glands supplied: 3.5 - 5mm (Blue) 5 - 7mm (Green) 6 - 8mm (Red) | 3.5 - 8mm With glands supplied: 3.5 - 5mm (Blue) 5 - 7mm (Green) 6 - 8mm (Red) | 3.5 - 8mm With glands supplied: 3.5 - 5mm (Blue) 5 - 7mm (Green) 6 - 8mm (Red) |
| Material: | Glass Filled Polyamide UL94V-0 | Glass Filled Polyamide UL94V0 | Glass Filled Polyamide UL94V0 | Glass Filled Polyamide UL94V0 |
| Sealing: | IP68 to BSEN 60529:1992+A2:2013 (10m depth for 2 weeks) | IP68 to BSEN 60529:1992+A2:2013 (10m depth for 2 weeks) | IP68 to BSEN 60529:1992+A2:2013 (10m depth for 2 weeks) | IP68 to BSEN 60529:1992+A2:2013 (10m depth for 2 weeks) |
| Salt Mist | EN60068-2-52 Test Kb Salt Mist (Cyclic) Marine Severity Level 1 | EN60068-2-52 Test Kb Salt Mist (Cyclic) Marine Severity Level 1 | EN60068-2-52 Test Kb Salt Mist (Cyclic) Marine Severity Level 1 | EN60068-2-52 Test Kb Salt Mist (Cyclic) Marine Severity Level 1 |
| Operating Temp Range: | -20°C to +70°C | -20°C to +70°C | -20°C to +70°C | -20°C to +70°C |
| Colour: | Black | Black | Black | Black |
| RoHS | Compliant | Compliant | Compliant | Compliant |



- ⊕ IP68 when mated, Tested in accordance with EN60529:1992+A2:2013
- ⊕ IP69K when mated, Tested in accordance with DIN 40050/Part 9 IP69k
- ⊕ EN60068-2-52 Test Kb Salt Mist (Cyclic) Marine Severity Level 1
- ⊕ HDMI 2.1 Performance
- ⊕ Shielded system
- ⊕ Single and double ended cables
- ⊕ Screw coupling
- ⊕ Resolutions and refresh rates of 8K at 60Hz and 4K at 120Hz
- ⊕ Hot pluggable, standard 19 contact interface
- ⊕ Alignment indicator reduces risk of damage during mating
- ⊕ High noise immunity and EMI protection
- ⊕ Secure, proven locking system
- ⊕ Direct mounting or via adaptor leads
- ⊕ Plug and play capability

Sealed HDMI Cables - Single Ended



PX0867

- Single ended sealed cable assembly
- IP68 HDMI connector to standard HDMI connector
- Mates with all panel mount connectors
- Available in 2m, 3m & 5m lengths

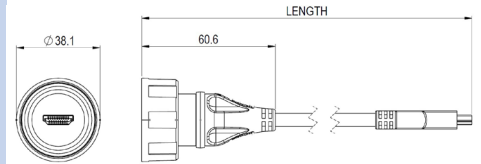

| Part no. | Length | Description |
|-------------|--------|--------------------------------------|
| PX0867/2M00 | 2m | IP68 HDMI male to standard HDMI male |
| PX0867/3M00 | 3m | IP68 HDMI male to standard HDMI male |
| PX0867/5M00 | 5m | IP68 HDMI male to standard HDMI male |

Sealed HDMI Cables - Double Ended



PX0868

- Double ended sealed cable assembly
- IP68 HDMI connector to IP68 HDMI connector
- Mates with all panel mount connectors
- Available in 2m, 3m & 5m lengths

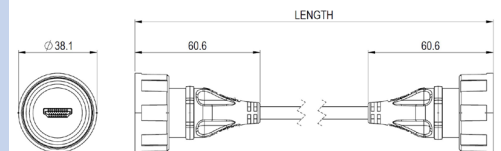

| Part no. | Length | Description |
|-------------|--------|----------------------------------|
| PX0868/2M00 | 2m | IP68 HDMI male to IP68 HDMI male |
| PX0868/3M00 | 3m | IP68 HDMI male to IP68 HDMI male |
| PX0868/5M00 | 5m | IP68 HDMI male to IP68 HDMI male |

Front Panel Mounting Connector



PX0863

- PX0863 – HDMI IP68 connector
- Female HDMI connector at rear of panel
- Mates with PX0867 and PX0868 cable connectors

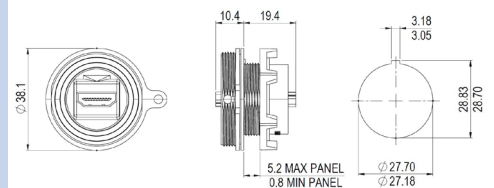

| Part no. | Description |
|----------|--|
| PX0863 | IP68 HDMI female, front panel mounted. Sealed HDMI at front of panel, standard HDMI type at rear |

Front Panel Mounting Connector



PX0863/1M00

- PX0863/1M00 – HDMI IP68 connector with 1m HDMI male lead at rear of panel
- Mates with PX0867 and PX0868 cable connectors

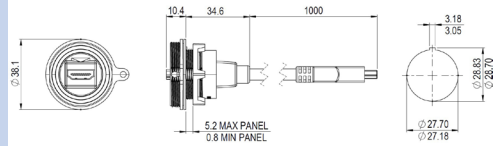

| Part no. | Length | Description |
|-------------|--------|--|
| PX0863/1M00 | 1m | IP68 HDMI female with 1m lead, front panel mounted, sealed HDMI at front of panel, standard HDMI at rear |

Rear Panel Mounting Connector



PX0869

- PX0869 – HDMI IP68 connector
- Female HDMI connector at rear of panel
- Mates with PX0867 and PX0868 cable connectors

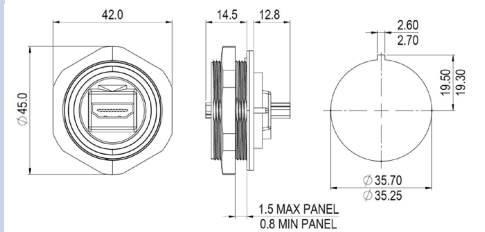

| Part no. | Description |
|----------|---|
| PX0869 | IP68 HDMI female, rear panel mounted, sealed HDMI at front of panel, standard HDMI type at rear |

Rear Panel Mounting Connector



PX0869/1M00

- PX0869/1M00 – HDMI IP68 connector with 1m HDMI male lead at rear of panel
- Mates with PX0867 and PX0868 cable connectors

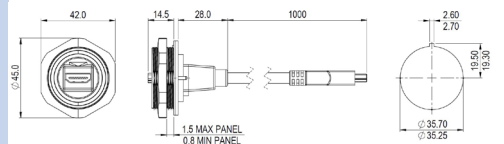

| Part no. | Length | Description |
|-------------|--------|--|
| PX0869/1M00 | 1m | IP68 HDMI female, with 1m lead, rear panel mounted, sealed HDMI at front of panel, standard HDMI at rear |

Accessories



Sealing Caps

- Sealing caps to maintain IP68 rating when connectors are not in use
- PX0835 for cable connectors PX0867 & PX0868
- PX0733 for front panel mount connectors PX0863, PX0863/1M00
- PX0711 for rear panel mount connectors PX0869, PX0869/1M00

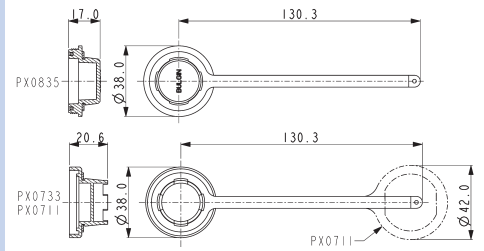

| Part no. | Description |
|----------|--|
| PX0835 | Sealing Cap for cable connectors (PX0867, PX0868) |
| PX0733 | Sealing Cap for front panel mounting connector (PX0863, PX0863/1M00) |
| PX0711 | Sealing Cap for rear panel mounting connector (PX0869, PX0869/1M00) |

Cables & connectors

| | |
|-----------------------|--|
| Mechanical | IP68, EN60529:1992+A2:2013 (10m depth for 2 weeks) |
| Sealing | IP69K, Tested in accordance with DIN 40050/Part 9 IP6k9k |
| Operating temperature | -25°C to +80°C |
| Salt Mist | EN60068-2-52 Test Kb Salt Mist (Cyclic) Marine Severity Level 1 |
| Electrical | |
| No. of Contacts | 19 |
| Current rating | 0.5A |
| Voltage rating | 30V AC (RMS) |
| Contact resistance | 40m Ω max. |
| Withstanding Voltage | 500V AC RMS |
| Performance | Ultra High Speed HDMI™ Cable with Ethernet |

Materials - Overmoulded

| | |
|---------------------|-------------|
| Overmould material | PVC (black) |
| Flammability rating | UL94V-0 |

Materials - Re-wireable and Panel Connectors

| | |
|-------------------------------|------------------------|
| Shell material | Steel |
| Shell plating | Nickel |
| Contact material | Brass |
| Contact plating | Tin & Gold |
| Connector body & locking ring | Glass Loaded Polyester |
| Panel connector | Acetal |
| Flammability rating | UL94 HB |
| 'O' rings | Silicone |
| Panel Gasket - round | Silicone |
| Panel Gasket - square | Neoprene |
| Mating cycles | 1,000 |
| RoHS | Compliant |

Materials - cable

| | |
|---------------------|---------------------------|
| Cable Jacket | PVC (black) |
| Braid | Aluminium-Magnesium Alloy |
| Screen Foil | Aluminium Foil |
| Insulation | HDPE and F-PE |
| Drain Wire | Tin-Copper Alloy |
| Flammability Rating | UL94V-0 |

| | | | |
|---------|-------|------------------------|------------------------|
| Length: | Dia | Conductors Signal | Conductors Power |
| 2m | 6.0mm | 4 x 30AWG | 5 x 30AWG |
| 3m | 6.0mm | 4 x 30AWG | 5 x 30AWG |
| 5m | 7.3mm | 1 x 28AWG 3 x 30AWG | 4 x 28AWG 1 x 32AWG |

Cable construction - PX0867, PX0868

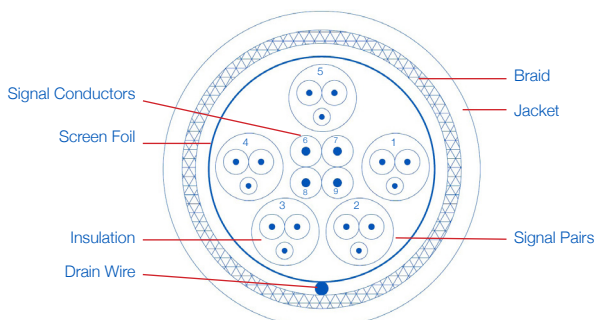



- IP68 when mated, tested in accordance with EN60529:1992+A2:2013
- IP69K when mated, tested in accordance with DIN 40050/Part 9 IP6k9k
- EN60068-2-52 Test Kb Salt Mist (Cyclic) Marine Severity Level 1
- USB version 2.0 and 3.0 performance
- Shielded system
- Single and double ended cables
- Screw coupling
- PCB mounted panel connector
- High-speed bus connection, USB 2.0: up to 480Mbps
USB 3.0: up to 5Gbps
- Hot pluggable, USB 2.0 with 4 contact interface, USB 3.0 with 9 contact interface
- Alignment indicator reduces risk of damage during mating
- High noise immunity and EMI protection
- Suitable for PC and peripheral configuration
- Secure, proven locking system
- Direct mounting or via adaptor leads
- Plug and play capability

Sealed USB Cables - Single Ended



PX0840/A



PX0840/B



PX0840/AA

- Single ended sealed cable assembly
- IP68 'A' type USB 2.0 connector to standard 'A' or 'B' type USB 2.0 connector
- IP68 'B' type USB 2.0 connector to standard 'A' type USB 2.0 connector
- IP68 'A' type USB 3.0 connector to standard USB 3.0 'A' type connector
- Mates with all panel mount connectors
- USB 2.0 variants available in 2m, 3m & 5m lengths
- USB 3.0 variants available in 1m, 2m & 3m lengths

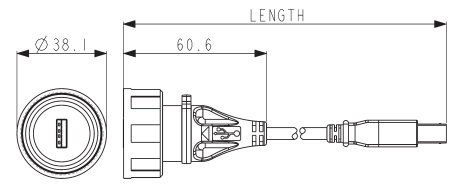

PX0840/A/xMxx

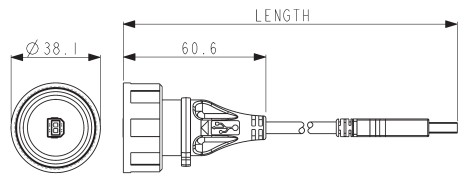

PX0840/B/xMxx

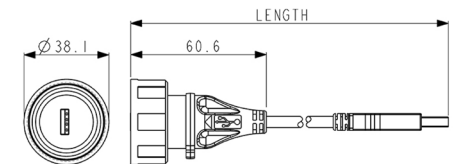

PX0840/AA/xMxx

| Part no. | Length | Description |
|----------------|--------|--|
| PX0840/A/2M00 | 2m | IP68 A type USB 2.0 to standard B type USB 2.0 |
| PX0840/A/3M00 | 3m | IP68 A type USB 2.0 to standard B type USB 2.0 |
| PX0840/A/5M00 | 5m | IP68 A type USB 2.0 to standard B type USB 2.0 |
| PX0840/B/2M00 | 2m | IP68 B type USB 2.0 to standard A type USB 2.0 |
| PX0840/B/3M00 | 3m | IP68 B type USB 2.0 to standard A type USB 2.0 |
| PX0840/B/5M00 | 5m | IP68 B type USB 2.0 to standard A type USB 2.0 |
| PX0840/AA/2M00 | 2m | IP68 A type USB 2.0 to standard A type USB 2.0 |
| PX0840/AA/3M00 | 3m | IP68 A type USB 2.0 to standard A type USB 2.0 |
| PX0840/AA/5M00 | 5m | IP68 A type USB 2.0 to standard A type USB 2.0 |
| PX0840/A3/1M00 | 1m | IP68 A type USB 3.0 to standard A type USB 3.0 |
| PX0840/A3/2M00 | 2m | IP68 A type USB 3.0 to standard A type USB 3.0 |
| PX0840/A3/3M00 | 3m | IP68 A type USB 3.0 to standard A type USB 3.0 |

Sealed USB Cables Double Ended



PX0841/AA



PX0841/AB

- Double ended sealed cable assembly
- IP68 'A' type USB 2.0 connector to IP68 'A' or 'B' type USB 2.0 connector
- IP68 'A' type USB 3.0 connector to IP68 'A' type USB 3.0 connector
- Mates with all panel mount connectors
- USB 2.0 variants available in 2m, 3m & 5m lengths
- USB 3.0 variants available in 1m, 2m & 5m lengths

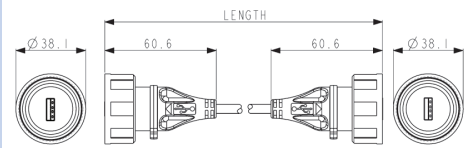

PX0841/AA/xMxx

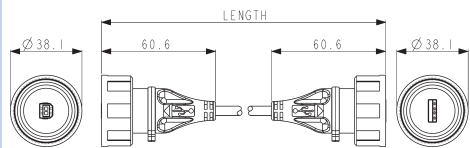

PX0841/AB/xMxx

| Part no. | Length | Description |
|----------------|--------|--|
| PX0841/AB/2M00 | 2m | IP68 A type USB 2.0 to IP68 B type USB 2.0 |
| PX0841/AB/3M00 | 3m | IP68 A type USB 2.0 to IP68 B type USB 2.0 |
| PX0841/AB/5M00 | 5m | IP68 A type USB 2.0 to IP68 B type USB 2.0 |
| PX0841/AA/2M00 | 2m | IP68 A type USB 2.0 to IP68 A type USB 2.0 |
| PX0841/AA/3M00 | 3m | IP68 A type USB 2.0 to IP68 A type USB 2.0 |
| PX0841/AA/5M00 | 5m | IP68 A type USB 2.0 to IP68 A type USB 2.0 |
| PX0841/A3/1M00 | 1m | IP68 A type USB 3.0 to IP68 A type USB 3.0 |
| PX0841/A3/2M00 | 2m | IP68 A type USB 3.0 to IP68 A type USB 3.0 |
| PX0841/A3/3M00 | 3m | IP68 A type USB 3.0 to IP68 A type USB 3.0 |

Front Panel Mounting Connector



PX0842/A

PX0842/B

- PX0842/A – USB 2.0 'A' type IP68 to USB 2.0 'B' type connector
- PX0842/AA – USB 2.0 'A' type IP68 to USB 2.0 'A' type connector
- PX0842/A3 – USB 3.0 'A' type IP68 to USB 3.0 'A' type connector
- PX0842/B – USB 2.0 'B' type IP68 to USB 2.0 'A' type connector
- Mates with PX0840 and PX0841 cable connectors

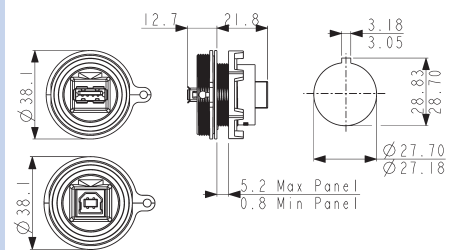

| Part no. | Description |
|-----------|--|
| PX0842/A | IP68 A type USB 2.0, front panel mounted. Sealed A type at front of panel, standard B type at rear |
| PX0842/B | IP68 B type USB 2.0, front panel mounted. Sealed B type at front of panel, standard A type at rear |
| PX0842/AA | IP68 A type USB 2.0, front panel mounted. Sealed A type at front of panel, standard A type at rear |
| PX0842/A3 | IP68 A type USB 3.0, front panel mounted. Sealed A type at front of panel, standard A type at rear |

Front Panel Mounting Connector



PX0843/B

PX0843/A

- PX0843/A – USB 2.0 'A' type IP68 connector with 5-way crimp connector
- PX0843/B – USB 2.0 'B' type IP68 connector with 5-way crimp connector
- PX0843/A3 – USB 3.0 'A' type IP68 connector with 10-way crimp connector
- Mates with PX0840 and PX0841 cable connectors

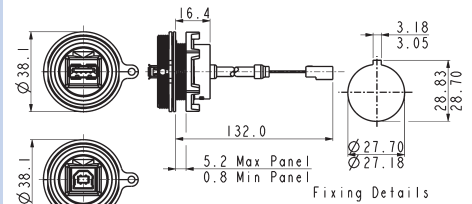

Part no.

Description

| | |
|-----------|--|
| PX0843/A | IP68 A type USB 2.0, front panel mounted. Sealed A type at front of panel, 5 way crimp connector at rear. |
| PX0843/B | IP68 B type USB 2.0, front panel mounted. Sealed B type at front of panel, 5 way crimp connector at rear. |
| PX0843/A3 | IP68 A type USB 3.0, front panel mounted. Sealed A type at front of panel, 10-way crimp connector at rear. |
| PX0460/A | As PX0843/A with exposed braid for use with PX0465 screening can |
| PX0460/B | As PX0843/B with exposed braid for use with PX0465 screening can |
| PX0460/A3 | As PX0843/A3 with exposed braid for use with PX0465 screening can |

Front Panel Mounting Connector



PX0844/B

PX0844/A

- IP68 Sealed through panel
- PX0844/A – USB 2.0 'A' type IP68 connector
- PX0844/B – USB 2.0 'B' type IP68 connector
- PX0844/A3 – USB 3.0 'A' type IP68 connector
- Standard USB interface plug options to rear of panel
- 0.5m standard cable length, other lengths available
- Mates with PX0840 and PX0841 cable connectors

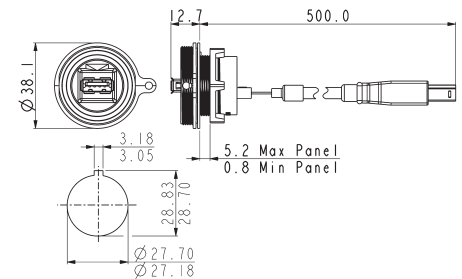

Part no.

Length

Description

| | | |
|-------------------|------|---|
| PX0844/A/0M50/A | 0.5m | IP68 A type USB 2.0, sealed through panel, Sealed 'A' type at front of panel, standard 'A' type at rear |
| PX0844/A/0M50/B | 0.5m | IP68 A type USB 2.0, sealed through panel, Sealed 'A' type at front of panel, standard 'B' type at rear |
| PX0844/B/0M50/A | 0.5m | IP68 B type USB 2.0, sealed through panel, Sealed 'B' type at front of panel, standard 'A' type at rear |
| PX0844/B/0M50/B | 0.5m | IP68 B type USB 2.0, sealed through panel, Sealed 'B' type at front of panel, standard 'B' type at rear |
| PX0844/A3/0M50/A3 | 0.5m | IP68 B type USB 3.0, sealed through panel, Sealed 'A' type at front of panel, standard 'A' type at rear |

Rear Panel Mounting Connector



PX0848/B

PX0848/A

- PX0848/A – USB 2.0 'A' type IP68 to USB 2.0 'B' type connector
- PX0848/B – USB 2.0 'B' type IP68 to USB 2.0 'A' type connector
- PX0848/A3 – USB 3.0 'A' type IP68 to USB 3.0 'A' type connector
- Mates with PX0840 and PX0841 cable connectors

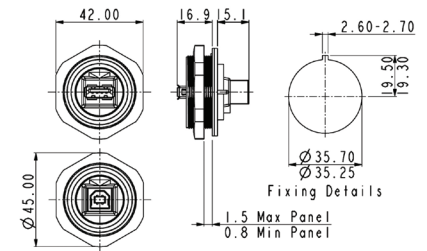

Part no. **Description**

| | |
|-----------|---|
| PX0848/A | IP68 A type USB 2.0, rear panel mounted. Sealed A type at front of panel, standard B type at rear |
| PX0848/B | IP68 B type USB 2.0, rear panel mounted. Sealed B type at front of panel, standard A type at rear |
| PX0848/AA | IP68 A type USB 2.0, rear panel mounted. Sealed A type at front of panel, standard A type at rear |
| PX0848/A3 | IP68 A type USB 3.0, rear panel mounted. Sealed A type at front of panel, standard A type at rear |

Rear Panel Mounting Connector



PX0849/B

PX0849/A

- PX0849/A - USB 2.0 'A' type IP68 connector with 5-way crimp connector
- PX0849/B - USB 2.0 'B' type IP68 connector with 5-way crimp connector
- PX0849/A3 - USB 3.0 'B' type IP68 connector with 10-way crimp connector
- Mates with PX0840 and PX0841 cable connectors

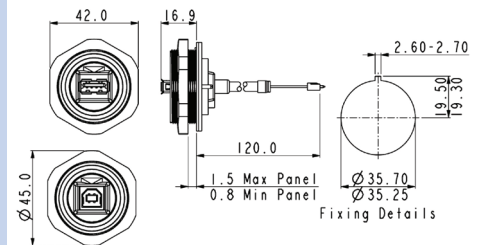

Part no. **Description**

| | |
|-----------|---|
| PX0849/A | IP68 A type USB 2.0, rear panel mounted. Sealed A type at front of panel, 5-way header at rear |
| PX0849/B | IP68 B type USB 2.0, rear panel mounted. Sealed B type at front of panel, 5-way header at rear |
| PX0849/A3 | IP68 A type USB 3.0, rear panel mounted. Sealed A type at front of panel, 10-way header at rear |

PCB Panel Mounting Connector- PCB Direct Mount



PX0845/B

PX0845/A

- PX0845/A – USB 2.0 'A' type IP68 connector
- PX0845/B – USB 2.0 'B' type IP68 connector
- PX0845/A3 – USB 3.0 'A' type IP68 connector
- PCB contacts at rear
- Direct PCB mount
- Mates with PX0840 and PX0841 cable connectors

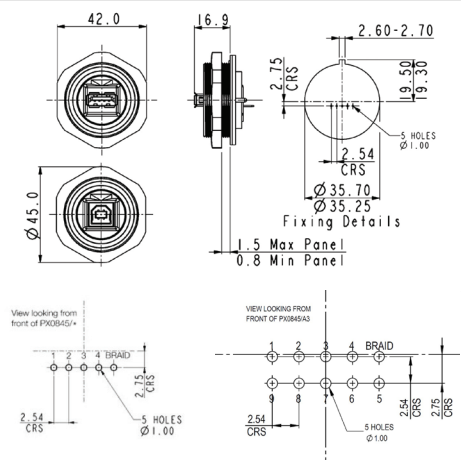

Part no. **Description**

| | |
|-----------|---|
| PX0845/A | IP68 A type USB 2.0, rear panel mounted. Sealed A type at front of panel, direct mount PCB contacts at rear |
| PX0845/B | IP68 A type USB 2.0, rear panel mounted. Sealed A type at front of panel, direct mount PCB contacts at rear |
| PX0845/A3 | IP68 A type USB 3.0, rear panel mounted. Sealed A type at front of panel, direct mount PCB contacts at rear |

PCB Adaptor Leads

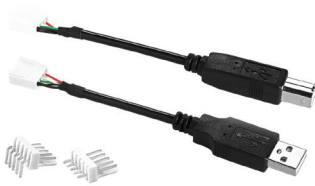

- Standard A and B type USB 2.0 connectors to 5-way crimp adaptor leads
- 5 way-headers, 2.54mm pitch, horizontal or vertical mounting
- Standard A type USB 3.0 to 10-way crimp adaptor leads

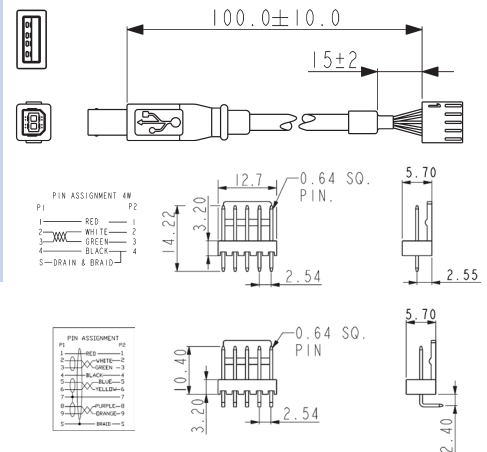

| Part no. | Description |
|----------|--|
| 14193 | USB 2.0 'A' type to 5-way crimp connector |
| 14194 | USB 2.0 'B' type to 5-way crimp connector |
| 100286 | USB 3.0 'A' type to 10-way crimp connector |
| 14191 | 5-way PCB header straight |
| 14192 | 5-way PCB header right angle |
| 100287 | 10-way PCB header straight |
| 100288 | 10-way PCB header right angle |

Accessories



- Sealing caps to maintain IP68 rating when connectors are not in use
- PX0835 for cable connectors PX0840 & PX0841
- PX0733 for front panel mount connectors PX0842, PX0843 & PX0844
- PX0711 for rear panel mount connectors PX0848, PX0849 & PX0845

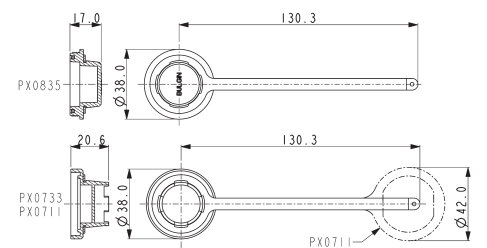

| Part no. | Description |
|----------|--|
| PX0835 | Sealing Cap for cable connectors (PX0840, PX0841) |
| PX0733 | Sealing Cap for front panel mounting connector (PX0842, PX0843 & PX0844) |
| PX0711 | Sealing Cap for rear panel mounting connector (PX0848, PX0849, PX0845) |

USB Flash Drive Cover



PX0852

- For use with USB Flash Drives
- Maintains IP68 rating when mated with panel connector
- For use with 'A' type connectors: PX0842, PX0843, PX0845, PX0848 & PX0849
- Internal accommodation 17.5 x 14.0 x 83mm approx.

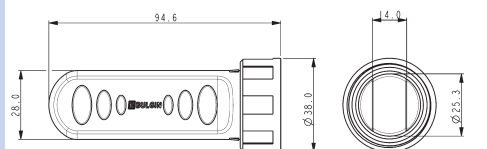

Screening Can



PX0465

- Maintains cable screening directly to panel
- Screening can clips around the panel fixing nut
- For use on PX0460/A, PX0460/B and PX0360/A3

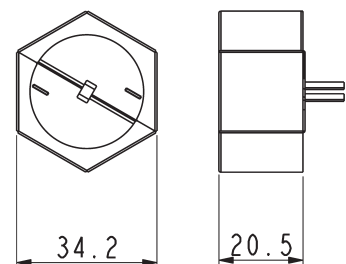

Cables & connectors

| | |
|-----------------------|--|
| Mechanical | IP68, EN60529:1992+A2:2013 (10m depth for 2 weeks) |
| Sealing | IP69K, Tested in accordance with DIN 40050/Part 9 IP6k9k |
| Operating temperature | 0°C to +70°C |
| Salt Mist | EN60068-2-52 Test Kb Salt Mist (Cyclic) Marine Severity Level 1 |
| Electrical | |
| No. of Contacts | 4 |
| Current rating | 1A |
| Voltage rating | 30V AC (RMS) |
| Contact resistance | 30m Ω max. |
| Performance | USB version 2.0 |

Materials - Overmoulded

| | |
|---------------------|-------------|
| Overmould material | PVC (black) |
| Flammability rating | UL94V-0 |

Materials - Re-wireable and Panel Connectors

| | |
|-------------------------------|------------------------|
| Shell material | Steel |
| Shell plating | Nickel |
| Contact material | Copper Alloy |
| Contact plating | 30 micro inch Gold |
| Connector body & locking ring | Glass Loaded Polyester |
| Panel connector | Acetal |
| Flammability rating | UL94 HB |
| 'O' rings | Silicone |
| Panel Gasket - round | Silicone |
| Panel Gasket - square | Neoprene |
| Mating cycles | 1,000 |
| RoHS | Compliant |

Materials - cable

| | |
|--------------|---------------------|
| Cable Jacket | PVC (black) |
| Screen | Tinned copper braid |
| Flammability | UL94V-0 |
| RoHS | Compliant |

| | | | |
|---------|-------|------------|------------|
| Length: | | Conductors | Conductors |
| | | Signal | Power |
| 2m | 4.8mm | 2 x 28AWG | 2 x 24AWG |
| 3m | 5.0mm | 2 x 28AWG | 2 x 22AWG |
| 5m | 5.2mm | 2 x 25AWG | 2 x 20AWG |

PCB adaptor leads

| | |
|-----------------------|--------------------|
| Electrical | |
| No. of conductors | 4 |
| Current rating | 1A |
| Voltage rating | 30V AC (RMS) |
| Contact resistance | <10m Ω max. |
| PCB pitch | 2.54mm |
| Materials | |
| Moulding | Polycarbonate |
| Flammability | UL94V-0 |
| Contact material | Copper Alloy |
| Contact plating | 30 micro inch Gold |
| Wire insulation | PVC (black) |
| Conductors | 4 x 28AWG |
| Operating temperature | 0°C to +70°C |
| Mating cycles | 1,000 |
| RoHS | Compliant |

USB 2.0 Cable construction - PX0840, PX0841

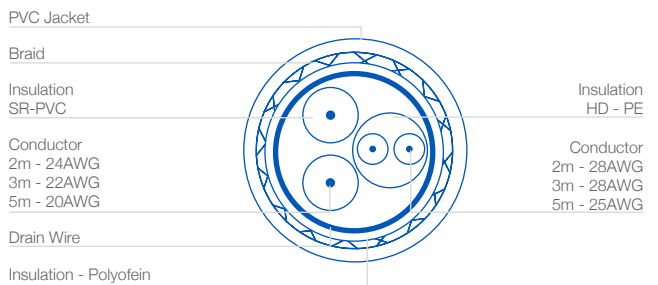

USB 2.0 Contact Diagram - PX0843 & PX0849

| P1 | TYPE | WIRE COLOUR | P2 |
|------------------|------|---------------|------------------|
| +5V 1 | — | RED | 1 +5V |
| USB- 2 USB+ 3 | ⊗ | WHITE / BLUE | 2 USB- 3 USB+ |
| GND 4 | — | BLACK | 4 GND |
| 5 | — | DRAIN & BRAID | 5 |

BUCCANEER FOR DATA

Standard Buccaneer - USB

USB 3.0 Specifications



Cables & connectors

| | |
|-----------------------|--|
| Mechanical | |
| Sealing | IP68, EN60529:1992+A2:2013 (10m depth for 2 weeks) |
| | IP69K, Tested in accordance with DIN 40050/Part 9 IP6k9k |
| Operating temperature | 0°C to +70°C |
| Salt Mist | EN60068-2-52 Test Kb Salt Mist (Cyclic) Marine Severity Level 1 |

| | |
|--------------------|-----------------|
| Electrical | |
| No. of Contacts | 9 |
| Current rating | 1A |
| Voltage rating | 30V AC (RMS) |
| Contact resistance | 30m Ω max. |
| Performance | USB version 3.0 |

Materials - Overmoulded

| | |
|---------------------|-------------|
| Overmould material | PVC (black) |
| Flammability rating | UL94V-0 |

Materials - Re-wireable and Panel Connectors

| | |
|-------------------------------|------------------------|
| Shell material | Steel |
| Shell plating | Nickel |
| Contact material | Copper Alloy |
| Contact plating | Gold |
| Connector body & locking ring | Glass Loaded Polyester |
| Panel connector | Acetal |
| Flammability rating | UL94 HB |
| 'O' rings | Silicone |
| Panel Gasket - round | Silicone |
| Panel Gasket - square | Neoprene |
| Mating cycles | 1,000 |
| RoHS | Compliant |

Materials - cable

| | |
|--------------|---------------------|
| Cable Jacket | PVC (black) |
| Screen | Tinned copper braid |
| Flammability | UL94V-0 |
| RoHS | Compliant |

| | | | | |
|---------|-------|------------|------------|-----------|
| Length: | | Conductors | Conductors | |
| | | Dia | Signal | |
| | 1m | 5.5mm | 7 x 28AWG | 2 x 24AWG |
| | 2m | 5.5mm | 7 x 28AWG | 2 x 24AWG |
| 3m | 5.5mm | 7 x 28AWG | 2 x 24AWG | |

PCB adaptor leads

| | |
|--------------------|--------------|
| Electrical | |
| No. of conductors | 9 |
| Current rating | 1A |
| Voltage rating | 30V AC (RMS) |
| Contact resistance | 30m Ω max. |
| PCB pitch | 2.54mm |

Materials

| | |
|-----------------------|---------------|
| Moulding | Polycarbonate |
| Flammability | UL94V-0 |
| Contact material | Copper Alloy |
| Contact plating | Gold |
| Wire insulation | PVC (black) |
| Flammability | UL94-V0 |
| Conductors | 9 x 28AWG |
| Operating temperature | 0°C to +70°C |
| Mating cycles | 1,000 |
| RoHS | Compliant |

USB 3.0 Cable construction - PX0840/A3, PX0841/A3

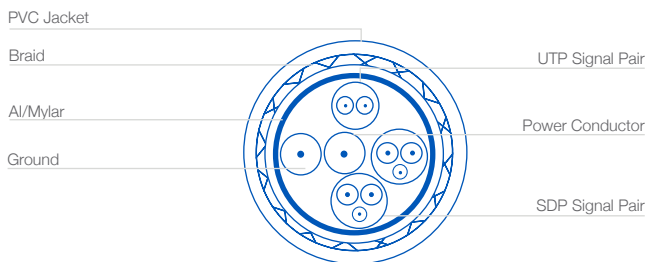

USB 3.0 Contact Diagram - PX0843/A3 & PX0849/A3

| P1 | TYPE | WIRE COLOUR | P2 |
|---------|------|-----------------|---------|
| +5V 1 | — | RED | 1 +5V |
| USB- 2 | ⊗ | WHITE / GREEN | 2 USB- |
| USB+ 3 | ⊙ | | 3 USB+ |
| GND 4 | — | BLACK | 4 GND |
| SSTX- 5 | ⊗ | BLUE / YELLOW | 5 SSTX- |
| SSTX+6 | ⊙ | | 6 SSTX+ |
| GND 7 | — | N/A | 7 GND |
| SSRX- 8 | ⊗ | PURPLE / ORANGE | 8 SSRX- |
| SSRX+9 | ⊙ | | 9 SSRX+ |
| S | — | BRAID | S |